

TLI-1550ES

- > RECHARGEABLE
- > High power + high energy
- > Extremely low self discharge rate
- > Charging possible at extreme temperatures

Performance Data

(Typical values for batteries stored at +25 °C for one year)

System	Lithium Intercalated Compounds	
Nominal voltage	4 V	
Max. capacity	1,400 mAh	
Max. continuous discharge current	5 A	
Pulse current capability	10 A	
Discharge end voltage	2.0 V	
Max. charge voltage	4.3 V	
Max. charge current	100 mA	20 mA
Temperature range	-20 °C ... +50 °C	-40 °C ... +85 °C
Cell impedance @ 1 kHz, RT	max. 100 mΩ	
Nominal energy	5.6 Wh	
Weight	22 g	



TLI-1550ES/Z2

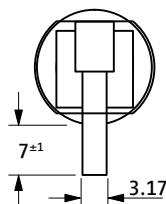
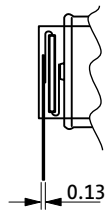
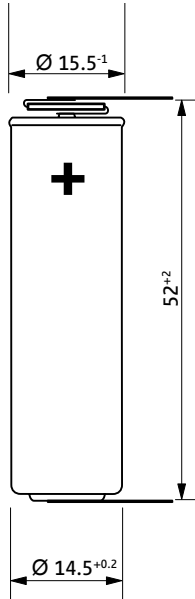

TLI-1550ES/Z2/T

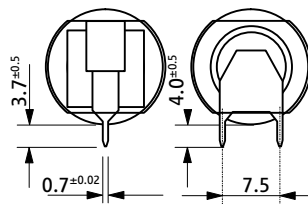
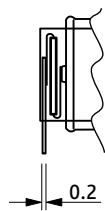

TLI-1550ES/Z2/TP

Warning:

Fire, explosion, and severe burn hazards. Do not disassemble, heat above 100 °C, short circuit, incinerate or expose contents to water.

Do not charge above 4.3 V. Please refer to TLI-guidelines.

Available Terminations

Termination	Tags*	Catalogue No.
TLI-1550ES/Z2/T	Tags*	on request
TLI-1550ES/Z2/TP	Polarized tags*	on request

* with PTC SRP 200

Any values given here are for informational purposes only. They also depend on actual conditions of use and are not warranties of future performance. Subject to change.

Discharge Curves at Room Temperature

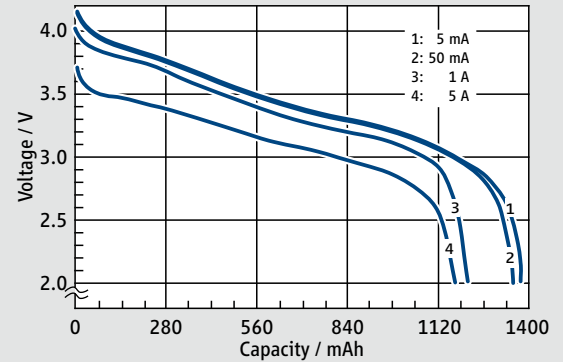

Pulse Capability at several Temp. @ 2 A

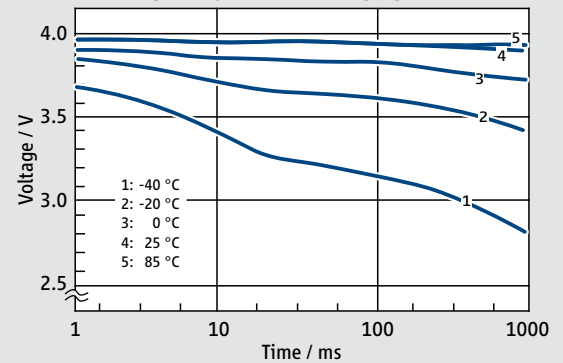

Charge (100 mA) / Discharge (350 mA) Cycling

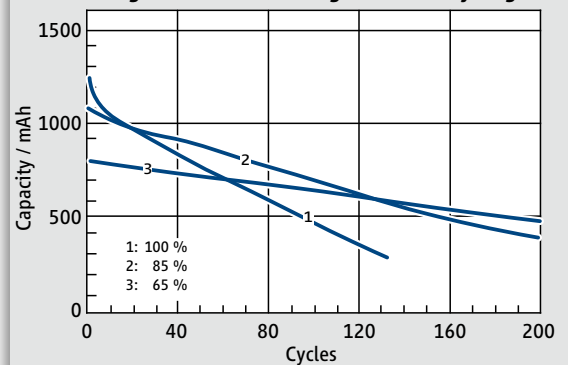

Capacity vs. OCV

