

TLM-1550ES

- > High power + high energy
- > No voltage delay
- > Long shelf life
- > End of life indication capability

Performance Data

(Typical values for batteries stored at +25 °C for one year)

System	Lithium Metal Oxide
Nominal voltage	4.0 V
Nominal capacity	1,400 mAh
Nominal current	5 mA
Max. continuous discharge current	5 A
Pulse current capability	10 A
Cell impedance	max. 100 mΩ
Lithium content	0.4 g
Weight	22 g
Volume	8 cm ³
Temperature range	-40 °C ... +85 °C



TLM-1550ES/S

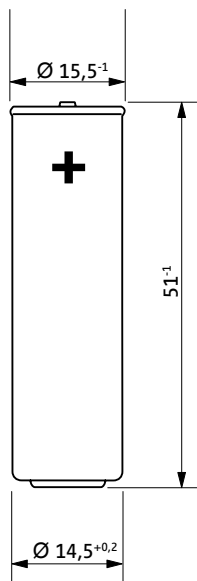

TLM-1550ES/Z2/T

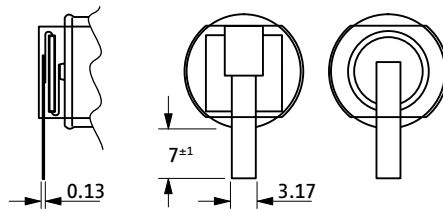

TLM-1550ES/Z2/TP

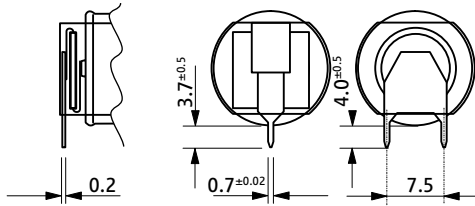

Available Terminations

Termination	Standard	Catalogue No.
TLM-1550ES/S	Standard	on request
TLM-1550ES/Z2/T	Tags*	on request
TLM-1550ES/Z2/TP	Polarized tags*	on request

* with PTC SRP 200

WARNING:

Fire, explosion, and severe burn hazard. Do not charge, disassemble, heat above 100 °C, incinerate, or short circuit.

Any values given here are for informational purposes only. They also depend on actual conditions of use and are not warranties of future performance. Subject to change.

Discharge Curves at Room Temperature

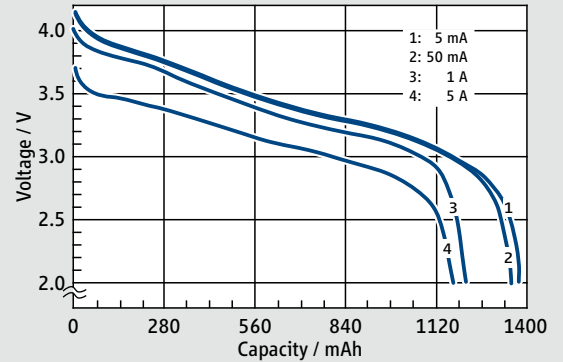

Pulse Capability at several Temp. @ 2 A

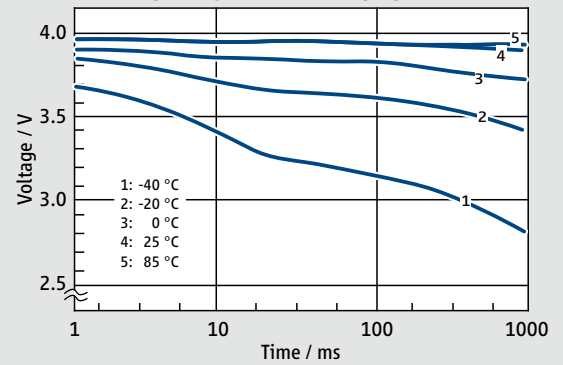

Accumulated Capacity Loss*

Storage Time [Y]	Storage Temperature		
	22 °C	55 °C	72 °C
1	3 %	6 %	10 %
5	7 %	22 %	40 %
10	11 %	32 %	n/a
15	15 %	42 %	n/a
20	18 %	n/a	n/a

* when tested at RT at 5 mA to 2.0 V

Capacity vs. OCV

