

SL-2870 Size: C

> XOL – extended operating life

Performance Data

(Typical values for batteries stored at +25 °C for one year)

| | |
|-----------------------------------|--------------------------|
| System | Lithium Thionyl Chloride |
| Nominal voltage | 3.6 V |
| Nominal capacity | 8.5 Ah |
| Nominal current | 3 mA |
| Max. continuous discharge current | 75 mA |
| Pulse current capability | 200 mA |
| Anode surface area | 30 cm ² |
| Lithium content | 2.5 g |
| Weight | 49.5 g |
| Volume | 26 cm ³ |
| Temperature range | -55 °C ... +85 °C |



Typical Discharge Curves at +25 °C

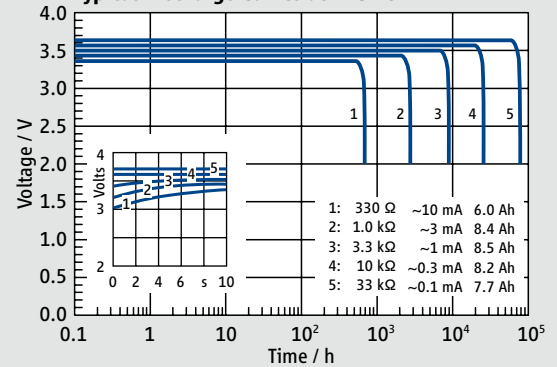

SL-2870/S

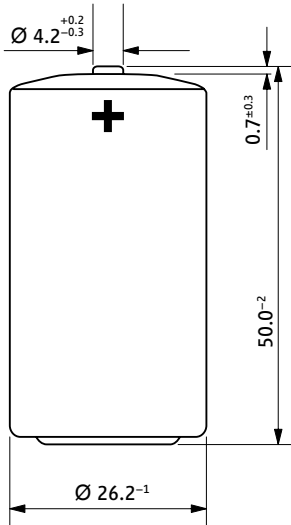

SL-2870/T

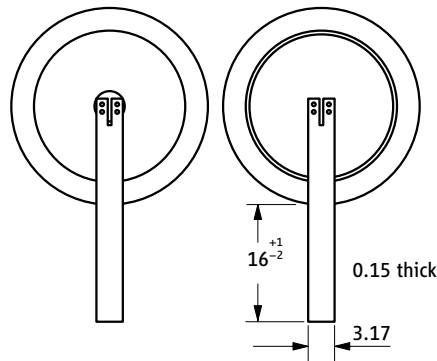

Available Capacity

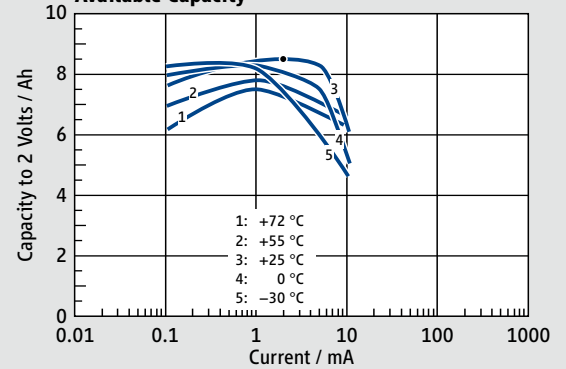

SL-2870/P

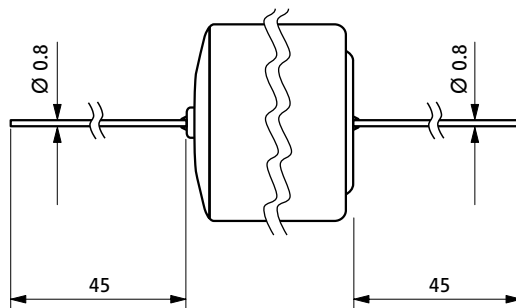

Operating Voltage

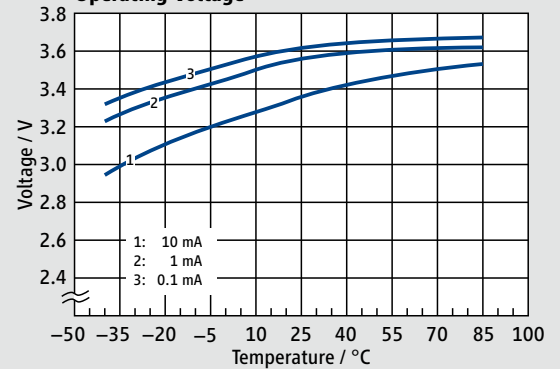

Available Terminations

| Termination | Standard | Catalogue No. |
|-------------|----------|---------------|
| SL-2870/S | Standard | 11 2 18701 00 |
| SL-2870/T | Tags | 11 2 18702 00 |
| SL-2870/P | Pins | 11 2 18703 00 |

WARNING: Fire, explosion, and severe burn hazard. Do not recharge, disassemble, heat above 100 °C, incinerate, or expose contents to water.

Any values given here are for informational purposes only. They also depend on actual conditions of use and are not warranties of future performance. Subject to change.