

# TLI-1550ES

- RECHARGEABLE
- High power + high energy
- Extremely low self discharge rate
- Charging possible at extreme temperatures

## Performance Data

(Typical values for batteries stored at +25 °C for one year)

System	Lithium Intercalated Compounds	
Nominal voltage	4 V	
Max. capacity	1,400 mAh	
Max. continuous discharge current	5 A	
Pulse current capability	10 A	
Discharge end voltage	2.0 V	
Max. charge voltage	4.3 V	
Max. charge current	100 mA	20 mA
Temperature range	-20 °C ... +50 °C	-40 °C ... +85 °C
Cell impedance @ 1 kHz, RT	max. 100 mΩ	
Nominal energy	5.2 Wh	
Weight	22 g	

For more information please refer to page 48.



## Discharge Curves at Room Temperature

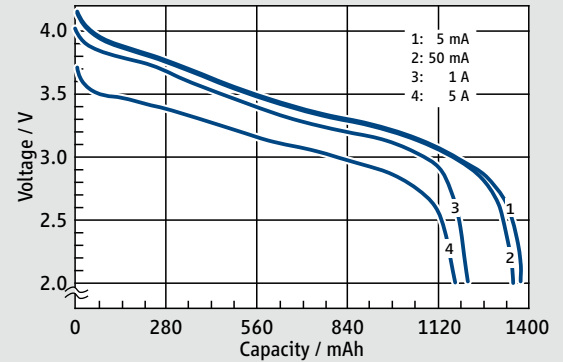

## Pulse Capability at several Temp. @ 2 A

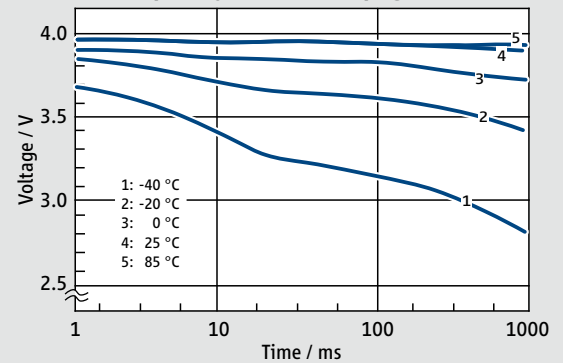

## Charge (100 mA) / Discharge (350 mA) Cycling

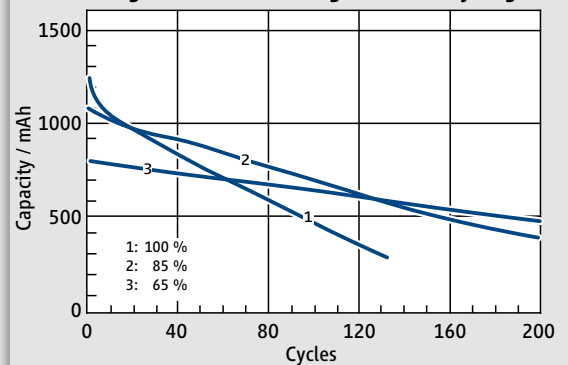

## Capacity vs. OCV

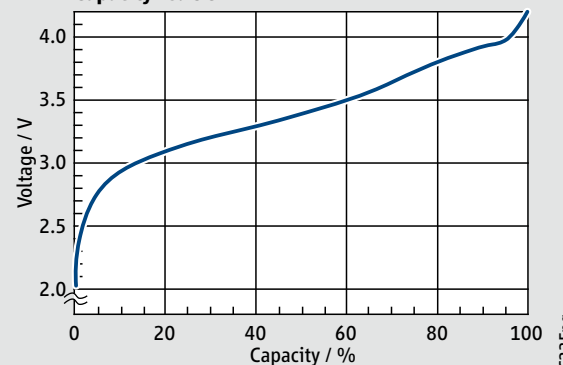

### TLI-1550ES/Z2

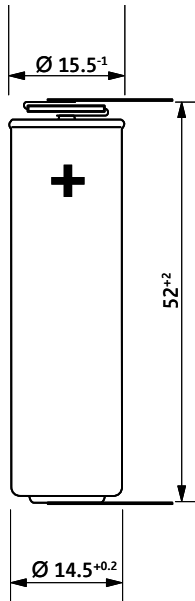

### TLI-1550ES/Z2/T

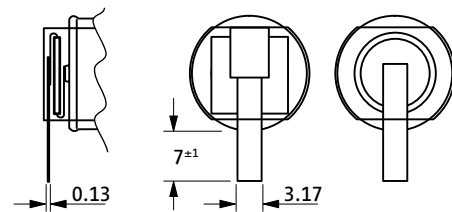

### TLI-1550ES/Z2/TP

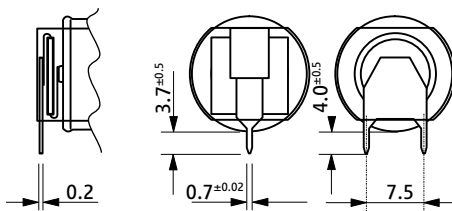

**Warning:**  
Fire, explosion,  
and severe burn hazards.  
Do not disassemble, heat  
above 100 °C, short circuit,  
incinerate or expose  
contents to water.

Do not charge above 4.1 V.  
Please refer to TLI-guidelines.

### Available Terminations

Termination	Tags*	Catalogue No.
TLI-1550ES/Z2/T	Tags*	on request
TLI-1550ES/Z2/TP	Polarized tags*	on request

\* with PTC SRP 200